

WINDSOR QUAY

— WINDSOR —

Contemporary three bedroom apartment with secure underground parking space. Set in a development next to the river Thames of Eton.

WINDSOR





KITCHEN

DESCRIPTION

A stunning second floor three bedroom luxury apartment in this contemporary riverside development. A stunning and contemporary second floor executive style apartment located in the prestigious Windsor Quay development which comprises of 16 dwellings lying adjacent to the River Thames and close to Eton bridge.

A well presented communal entrance with video entry system and lift gives access to this high specification apartment with attention given to detail throughout with a striking open plan kitchen/living room with a Schiffini fitted kitchen with a range of integrated Kuppertsbush appliances granite worktops, solid wood flooring and bi-folding doors giving access to a South facing balcony with views of the castle.

There are two high quality bathroom suites with porcelain flooring, multimedia system with inset speakers and under floor heating.

Underground is a secure private car park with allocated space and a most useful storage compartment.





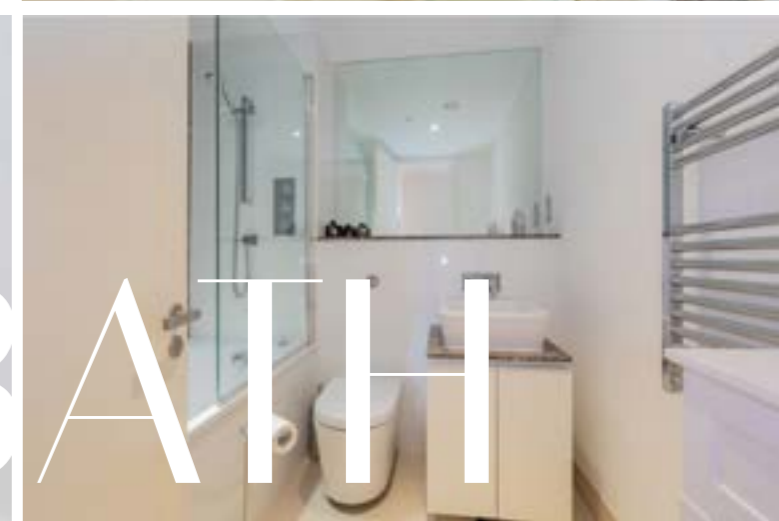

BEDROOMS & BATH

LOCATION

The property is situated in one of Windsor's finest locations. Across the bridge river is Eton High Street with its range of individual retailers, boutiques, restaurants and antique shops. Windsor is surrounded by miles of beautiful countryside yet is still within easy commuting distance of Central London and offers extensive shopping amenities, restaurants, theatres, night life and museums.

Rail connections to London Waterloo (approx. 56 minutes) are available from Windsor & Eton Riverside and to Paddington (about 30 minutes), via Slough, from Windsor Central (both stations are extremely close by). Both Junctions 5 and 6 of the M4 are within easy reach and provide access to Heathrow, Central London, the West Country and the M25.

Sporting/leisure facilities are varied, with golf at Sunningdale, Wentworth and Datchet, horse riding at both Windsor and Ascot, polo and horse riding in Windsor Great Park, boating on the River Thames and athletics at the Thames Valley Athletics Centre in Eton.



POSTCODE: SL4 1AE



Approx. Gross Internal Floor Area
1249 Sq Ft 116 Sq Metres

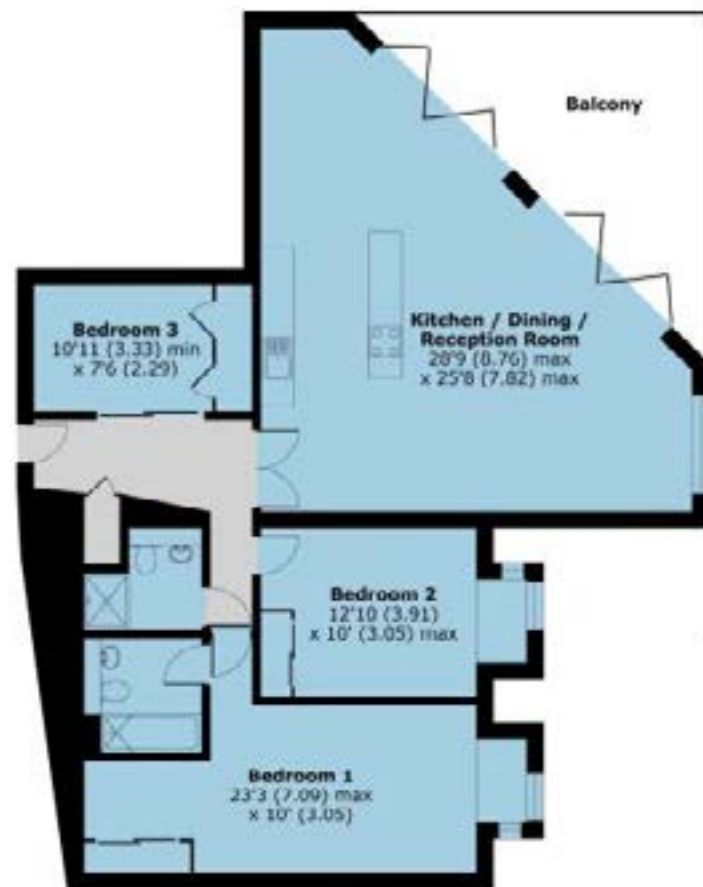

WARREN
PROPERTY MATTERS

Warren Property Matters

104-105 High Street | Eton | Windsor | Berkshire | SL4 6AF

sales@warrenproperty.co.uk
+44 (0) 1753 625 100

warrenproperty.co.uk